

TOPZERO®

Seamless Edge Sinks

INSTALLATION INSTRUCTIONS

 www.TOPZERO.com

Watch the TopZero
Sink Installation video
on **You**Tube****

Customer Support:
1-844-TOPZERO
(867-9376)

follow / like us @



TOPZERO®

Step 1:
(CUTTING OUT THE SINK HOLE)

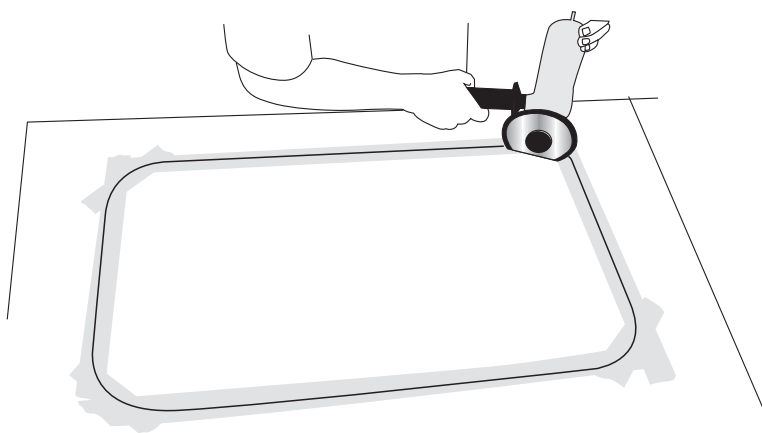
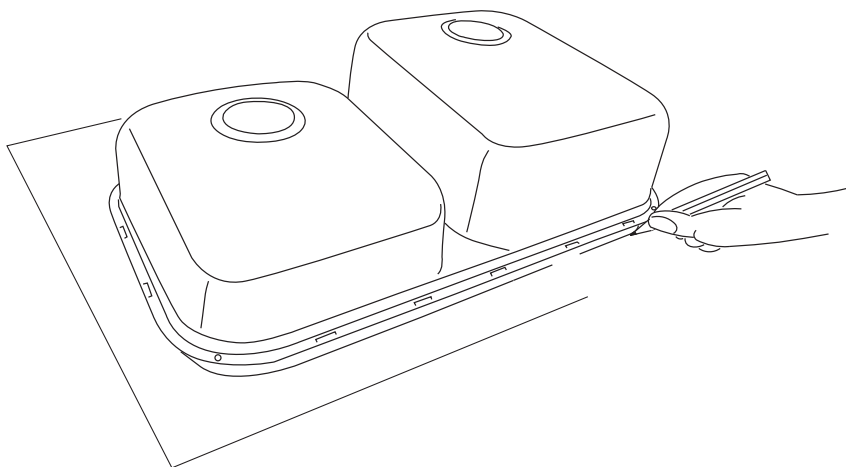

TOPZERO®

- Before installing TopZero sink, visually check for any defects, or damages. Check mounting flange and the edgeless rim, as well as the bowls

The mounting flange perforated surface shall be perpendicular to the sink walls

- Bend the mounting brackets/flange with force of hand if necessary

Sink cut-out can be performed with automated CNC equipment, or water-jet by using the electronic template provided, or it can be done manually

- Locate where the sink needs to be positioned on the front side of the granite countertop
- Mark the sink center line. Then mark a second line 3-1/2" to 4" back from the front edge of the countertop
- Lay the sink upside down on the template paper. Trace the outline of the sink edge with a fine point marker, cut out the template precisely using scissors or blade
- Turn over the template and place it on the front face of the granite

The template is flipped because the sink might not be 100% symmetric due to its rimless nature

- Tape the template on the granite and trace the outline with a fine point marker. Remove the template
- Use a grinder with a diamond blade to cut out the sink hole in the granite finished side up

The rimless TopZero sink will be inserted into the countertop from underside through the sink hole preferably tight, therefore the cutting shall be precise to 1/16" or less. Corners of TopZero are more solid than the sides which are flexible due to the rimless nature of the sink. Extra precision is needed while cutting on corner lines. The rimless sink edge is flexible, therefore the joint between the countertop material, and stainless steel edge can be minimized using spreader clamps, or tension rods while the sink is glued into the sink hole permanently

TOPZERO®

- When the cut out is complete, insert the sink into the sink hole. Grind the edges more as needed in order to fit the sink in place
- Turn the countertop finished side down. Make a thick 1/4" bevel on the back side of the granite edge around the sinkhole

This bevel helps the sink to easily penetrate into the sinkhole, while it also serves like a ditch at the joint around the sinkhole, which to be filled with acrylic in the permanent mounting step, making a continuous bond, and watertight seam between the granite and the stainless steel sink

- Trace the outline of the mounting brackets on the granite and mark location of the bracket center holes on the granite

- Remove the sink, and drill just one hole marked on each side of the sink. Place the insert nuts into the holes, and glue the nuts into the holes

• **Second option to drilling holes on granite:** Cut a groove using the grinder at the bracket center hole locations marked for anchoring. Fill the grooves with acrylic. Wipe excessive acrylic, make it flat even with the surface. Place the sink into the sinkhole. Push it in firmly until the brackets are 1/16" away from the granite surface. Place shims under the brackets so that the brackets do not touch the granite surface. Place the insert nut/wing-nut/screw assembly into the grooves, until the insert nuts sink flush in the acrylic mud. Wait 10-15 minutes until the acrylic mud hardens. Unscrew the anchoring assembly, leaving the insert nut glued flush in the grooves

• **Third option to drilling holes on granite:** Use the same anchoring method as in with undermount sink install. Cut a groove on each side of the sink hole approximately 3" away from the sink-cut out line. Fill the grooves with acrylic and place the insert nuts into the grooves. The wing-nut/screw assembly will be used to hold the sink in place until the bonding acrylic glue cures, while it will also be useful to adjust the height of the rimless tip of the sink against the upper edge of the granite

TOPZERO®

Step 2: (PERMANENT SINK MOUNTING / IN-SHOP INSTALLATION)

RECOMMENDED SUPPLIES:

- * TopZero Non-Sag seaming acrylic adhesive
- * 10 to 1 acrylic gun
- * Denatured Alcohol
- * Spreader Clamps
(sold at Home Depot, or Lowes_ Trigger clamp that converts to a spreader)
- * Popsicle sticks
- * Terry cloth towel

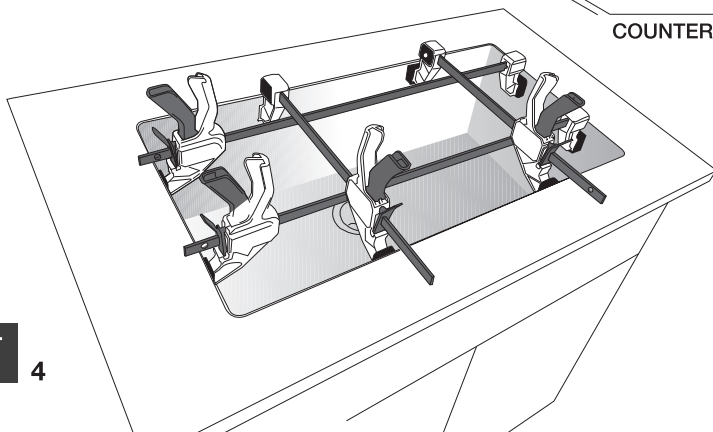
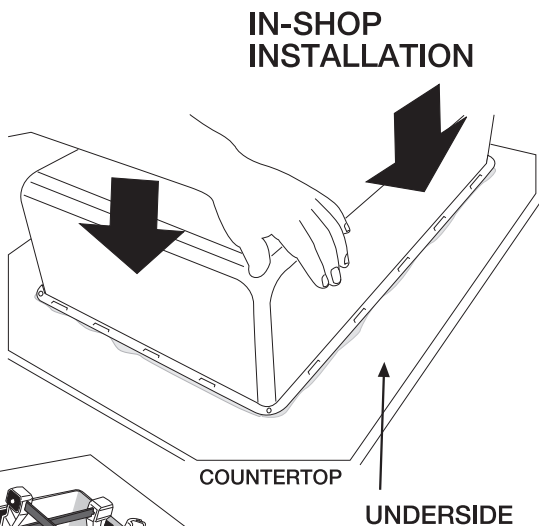
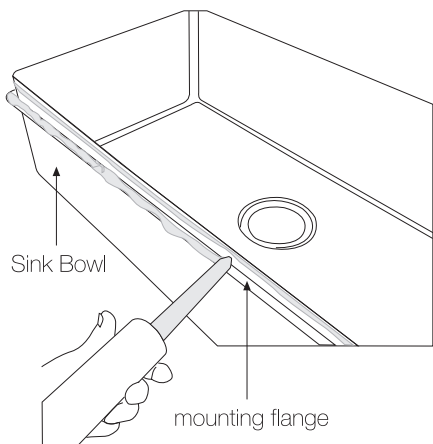

TOPZERO®

- Countertop finished side down, Clean the edge of the sink hole around the cut-out with denatured alcohol
- Apply a thick bead of acrylic on the sink wall continuously around the sink edge over the bracket line, as well as on the perforated surface of the mounting flanges.
- Place the sink into the granite, and firmly push it in. Observe the acrylic smooches in the joint and spreads in between the flange and granite surface. Force the acrylic bead into the joint, smoothing it with a popsicle stick
- Take the four screw-wing-nut-washer assembly. Position the wing-nut and washer all the way up to the screw head
- Screw the assembly into the holes on the granite. Turn the wing-nuts until they touch the bottom plate of the brackets
- Turn the granite piece finished side up. Observe the location of the stainless tip against granite edge

The stainless edge shall be approximately 1/8" lower than the granite edge all along The 1/8" drop is critical for the acrylic glue to better stick on to the vertical granite edge

- Loose the wing-nuts and push down the sink slightly, as needed, in order to level the stainless tip all around the sink hole with 1/8" drop. Use spacers, or shims between the granite and mounting flange if necessary for leveling
- Place tension rods or spreader clamps in the sink in between opposing walls, in order to make the seam as tight as possible before the acrylic glue cures. Wait 15-20 minutes until the acrylic glue hardens
- Remove the tension rods or spreader clamps

TOPZERO®

Step 2: (PERMANENT SINK MOUNTING / JOBSITE INSTALLATION)

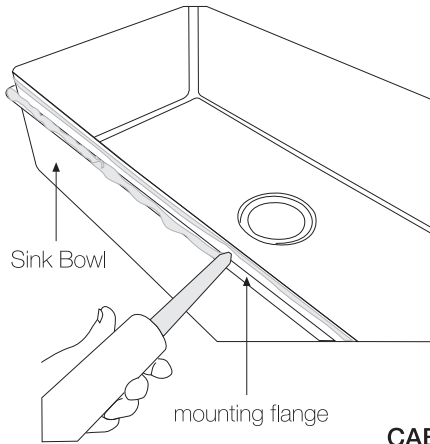

RECOMMENDED SUPPLIES:

- * TopZero Non-Sag seaming acrylic adhesive
- * 10 to 1 acrylic gun
- * Denatured Alcohol
- * Spreader Clamps (sold at Home Depot, or Lowes_ Trigger clamp that converts to a spreader)
- * Popsicle sticks
- * Terry cloth towel

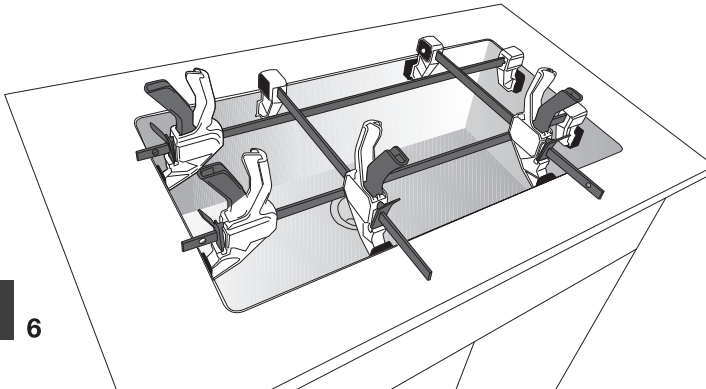
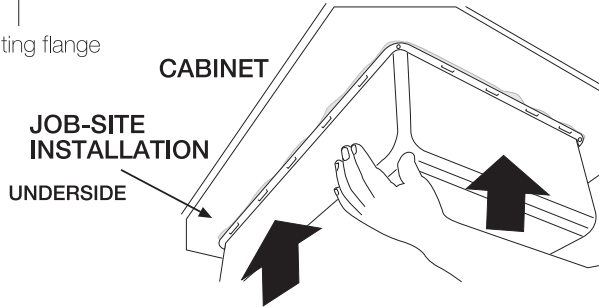

TOPZERO®

- Finish countertop install on the cabinets. If there is a seam around the sinkhole, make sure the seam is glued tight and both granite sides are on the level
- Clean the mounting flange and the edge of the sink hole around the cut-out with denatured alcohol
- Apply a thick bead of acrylic on the sink, continuously around the sink edge over the flange line, as well as on the perforated surface of the mounting flange
- Cover the sink cabinet base with a blanket to avoid staining
- Place the sink into the granite, and firmly push it in. Observe the acrylic smooches in the joint and spreads in between the flange and granite surface. Force the acrylic bead into the bevel smoothing it with a popsicle stick
- Take the four screw-wing-nut-washer assembly. Position the wing-nut, and washer all the way up to the screw head
- Screw the assembly into the holes on the granite. Turn the wing-nuts until they touch the bottom plate of the brackets

Observe the location of the stainless tip against granite edge. The stainless edge shall be approximately 1/8" lower than the granite edge all along. The 1/8" drop is critical for the acrylic adhesive to better stick on to the vertical granite edge

- Loose the wing-nuts and push down the sink slightly, as needed, in order to level the stainless tip all around the sink hole with 1/8" drop. Use spacers or shims between the granite and mounting flange if necessary for leveling
- Place tension rods or spreader clamps in the sink in between opposing walls, in order to make the seam as tight as possible before the acrylic adhesive cures. Wait 15-20 minutes until the acrylic adhesive hardens
- Remove the tension rods or spreader clamps

TOPZERO®

Step 3: (FRONT FACE JOINT FEATHERING)

RECOMMENDED SUPPLIES:

- * TopZero nonsag seaming acrylic adhesive (with color tints if necessary)
- * 10 to 1 acrylic gun
- * Popside sticks
- * Variable speed grinder with several grade sand-papers.
- * Masking tape
- * Denatured alcohol
- * Razor blade
- * Safety glasses & mask

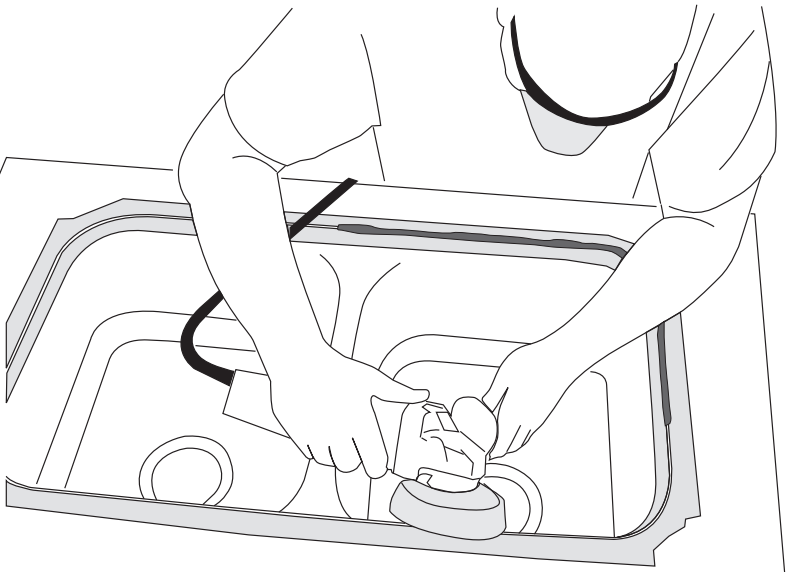
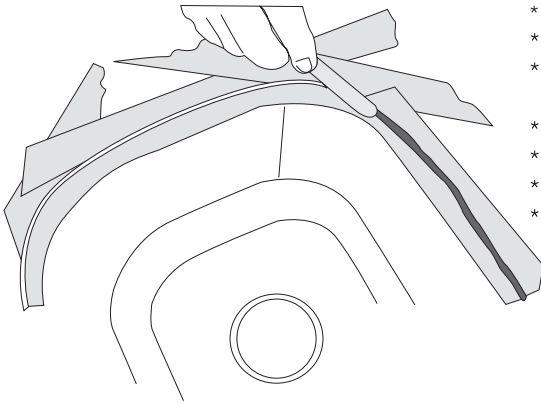

TOPZERO®

- Cover the edge of the granite and stainless steel wall with masking tape, leaving approximately 1/16" space both on the granite and the stainless steel
- Mix color tints in the acrylic to match the color of the countertop material for seamless appearance
- Apply the color-mixed acrylic on the seam, forcing it into the joint using popsicle sticks
- After the acrylic sets, sand and polish the joint with orbital, drum or palm sander. Keep sanding evenly around the sink hole until the stainless steel edge line appears
- Make a fine, micro bevel on the granite
- Remove the masking tape
- Scrap remaining acrylic on the granite, and stainless steel with a fine razor blade
- Clean the edge with denatured alcohol
- Rinse the sink basin with water and remove residue before wiping to avoid scratching the sink surface.

